

Garden **GRD™** "Midi"
Safety Hedge Trimmer





Intended use

Your Garden Groom is a power tool that is used for trimming hedges, bushes, shrubs and ornamental plants and works with a rotating blade. The maximum branch thickness to be cut should not exceed 10 mm. The intended use of the Garden Groom is for outdoor and private domestic garden areas. Before each operation, read the manual.

When using the Garden Groom ensure the appropriate personal protective equipment is worn according to the manual and the warning pictograms attached to the machine. Before using Garden Groom, check for any electrical or mechanical damage. If damage is detected, do not use and contact an authorized service center.

Improper use

All applications for Garden Groom that are not listed in the "intended use" paragraph are considered as a non-intended use.

Any resulting property damage and personal injury incurred due to any misuse, shall be the liability of the user of the Garden Groom.

Using other or non-original components on the Garden Groom, will void the manufacturer's warranty.

Remaining risks

Even with proper use of the Garden Groom, there is always some residual risk that cannot be ruled out. For the type and construction of the tool, the following potential hazards, need to be considered.

- Contact with the unprotected blade (cut-injury)
- Hand or bodily contact with the moving blade area. (cut-injury)
- Unforeseen, sudden movement of the cutting material (cut-injury)
- Projection of the cutting material
- Damage to hearing, if there is no suitable hearing protection worn
- Inhalation of cut material

Please Note: All photographic images in this manual and packaging are for marketing purposes only. For full safety instructions, please refer to the contents of this manual

History and Background

Several years ago, Graham Wilson a retired engineer was cutting hedges in his garden. After a long hard day he said to himself, there must be an easier and safer way to do this job!!

So he set about trying to solve the problems that all gardeners face when they venture out to cut their hedges.

At first it started out as a hobby, but the more Graham got closer to solving the problems, the more determined he was to see the job through. In 2000, he received a number of UK government grants for safety and innovation, which helped him fund the initial stages of the project. He then approached a number of leading garden tool manufacturers, with a view to them taking on his invention. Without exception they all rejected his concept.

Graham however was determined to see his vision through. He was convinced he had a concept that would dramatically benefit gardeners around the world, that concept would change a potentially dangerous and time consuming chore, into a far more pleasant and safe gardening function.

To achieve his goal Graham needed to raise substantial funds and in 1999,



Graham Wilson - Inventor and Chairman of Garden Groom

at the age of 53, he re-mortgaged his home and ploughed all of his savings into the development of his invention.

Years on and after spending a small fortune on development, manufacturing and patent costs and with many disappointments and rejections along the way, Graham has succeeded in introducing the GARDEN GROOM to gardeners around the world.

He has truly solved the problems associated with hedge trimming and with the GARDEN GROOM has presented a unique product that cuts, shreds and captures the majority of waste material and with its concealed blade, makes it virtually impossible to cut the mains cable.

Great ideas are always worth fighting for!
Thanks Graham.



Location of rating plate and switches

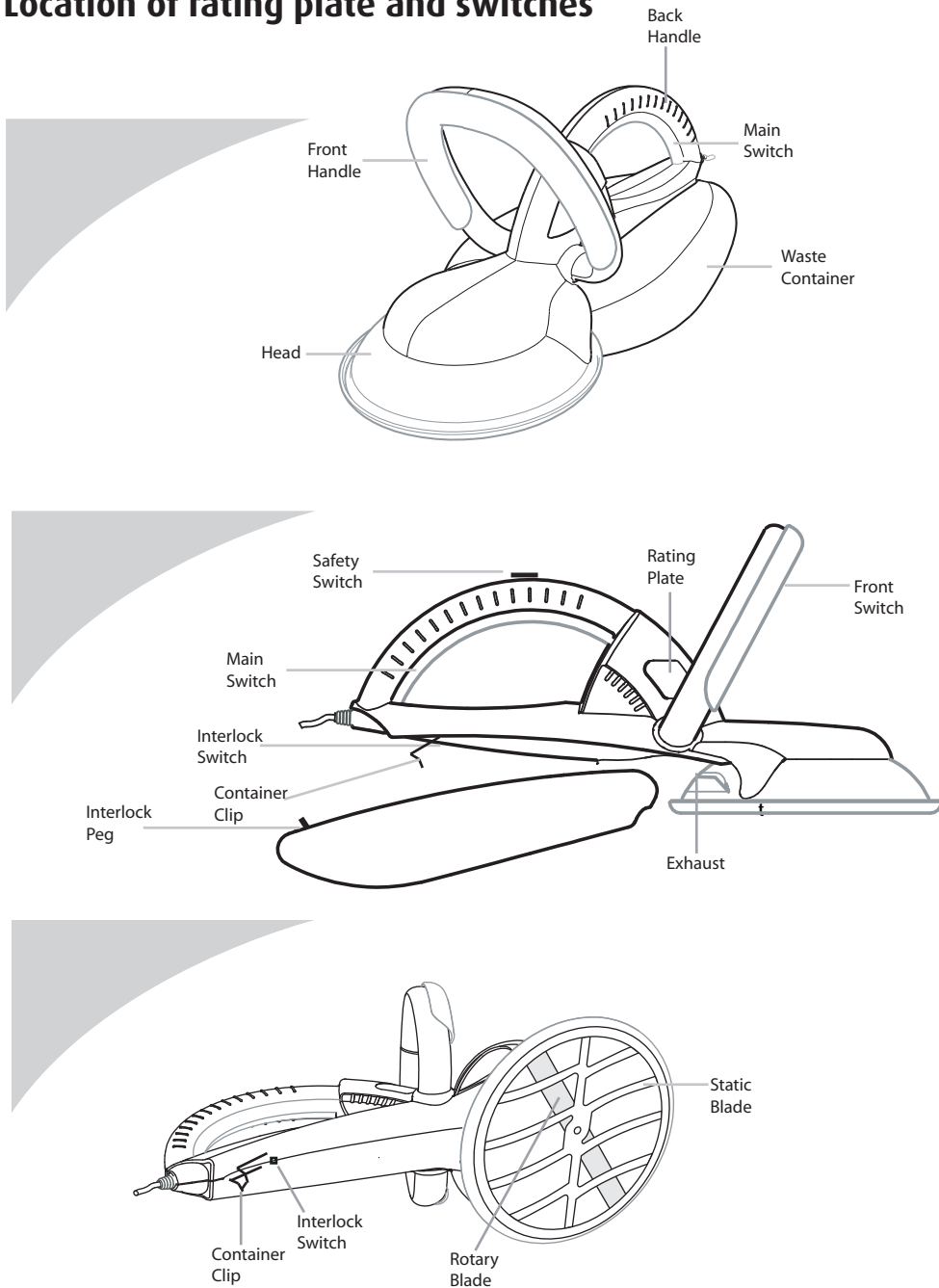

1. SWITCH ARRANGEMENT

Your Garden Groom Midi will operate when the main switch and the front switch located on the front handle are depressed. To operate the main switch, push forward the safety switch first.

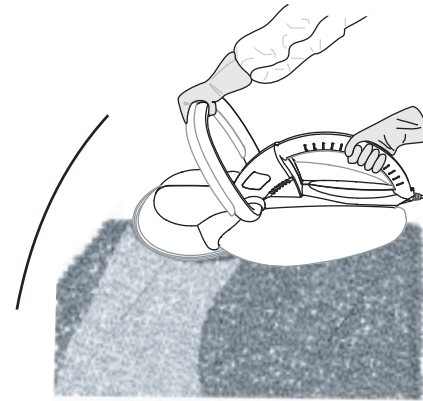
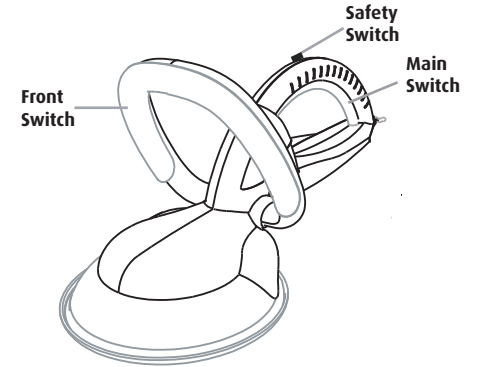

2. HORIZONTAL TRIMMING (Top of Hedges)

Move the Garden Groom Midi in a sweeping pendulum motion from side to side. The flat underside of the Garden Groom Midi provides a natural guide, so the most inexperienced gardener can achieve excellent results. TIP: The Garden Groom Midi has been designed to cut growth of up to 1 year in age, 10mm in diameter. Use on heavier material may result in damage to the machine.

3. VERTICAL TRIMMING (Side of Hedge)

Move the Garden Groom Midi in a vertical sweeping action, ensuring the flat underside of the machine is level with the surface of the hedge. TIP: For a tighter professional finish, bury the head of the machine into the hedge, to the desired depth, working the machine upwards. See fig.2 (below). To trim long stalks growing parallel with the surface of the hedge, move the head down in the opposite direction to the growth (fig.3)

Please note: The capture rate of material is reduced using this able of cut.

Fig.1

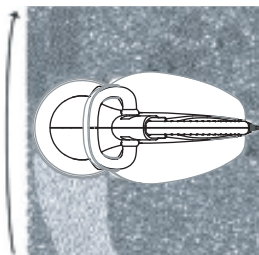

Fig.2 — Hedge level

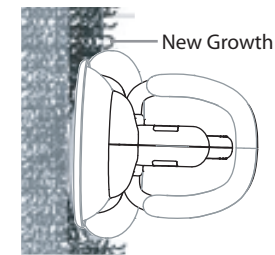
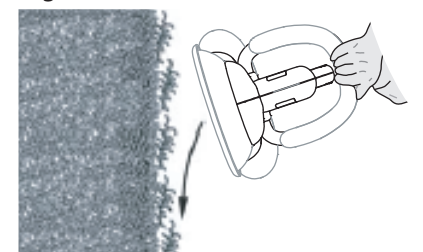

Fig.3





4. TRIMMING EXTRA LONG GROWTH

The Garden Groom Midi has been designed to trim hedge growth of 150mm or less. However, it will trim exceptionally long growth, but this operation will inevitably result in a lower rate of capture (on vertical cuts only), due to the sheer dynamics and volume of material to be managed.

To trim exceptionally long growth (within the recommended cutting diameters), we advise the following techniques: Trim the growth in several stages (see fig.1 below) layering down, until you arrive at the desired level.

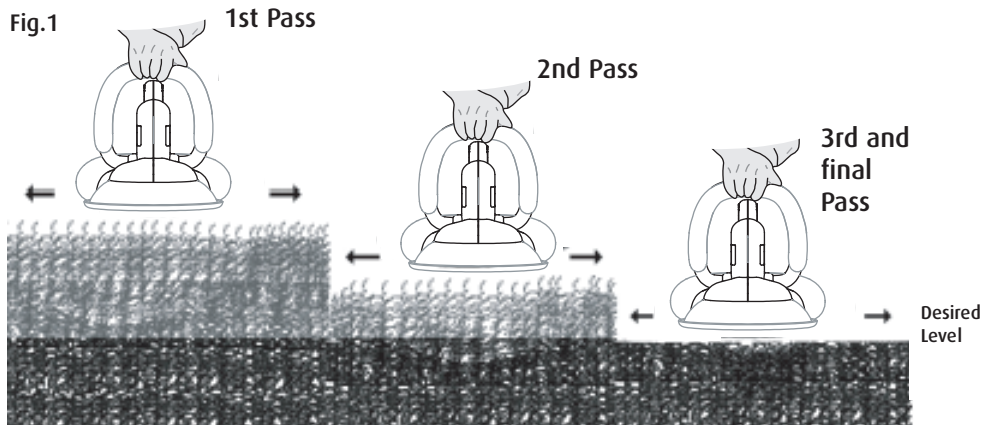

In some circumstances you may wish to adopt a vertical technique (see fig.2 below), bringing the Garden Groom down onto the growth in a vertical action.

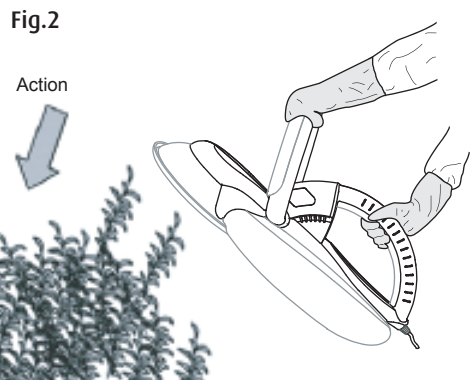

Tip: We strongly recommend regular use of the Garden Groom Midi, which will produce exceptional performance, speed of operation and ensure professional results.

5. EMPTYING CONTAINER

For speed of operation, simply hold the Garden Groom Midi by the front handle, unclip and withdraw the container from the main body and deposit the waste material into an appropriate receptacle. To re-engage, push the front of the container over the exhaust, raise the rear of the container, ensuring alignment with clip, push clip forward with palm of hand to lock. Note: The interlock peg MUST be connected to the interlock switch for the machine to function.

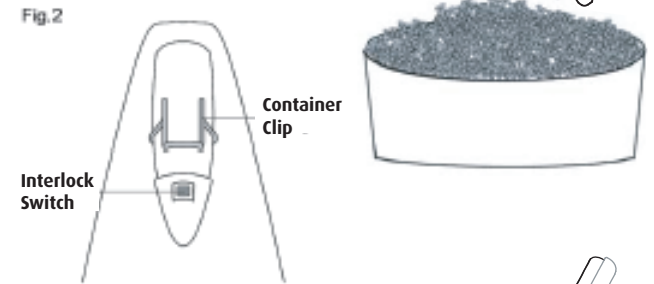
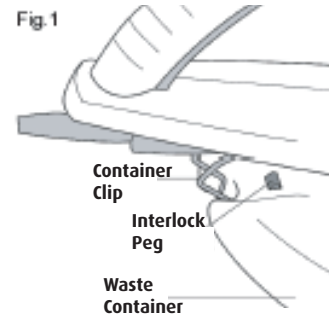
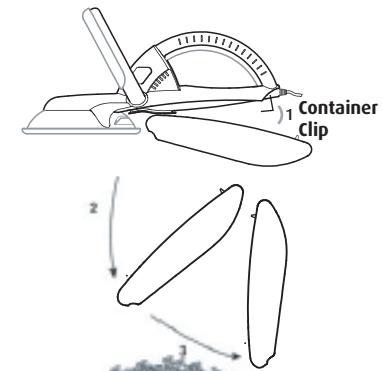

6. VOLUME BAG ATTACHMENT

For larger areas of hedge growth, a volume bag attachment has been developed. This accessory has a specifically refined container fixed to an exhaust hose and volume bag attachment and is fitted in the same manner as the standard container.

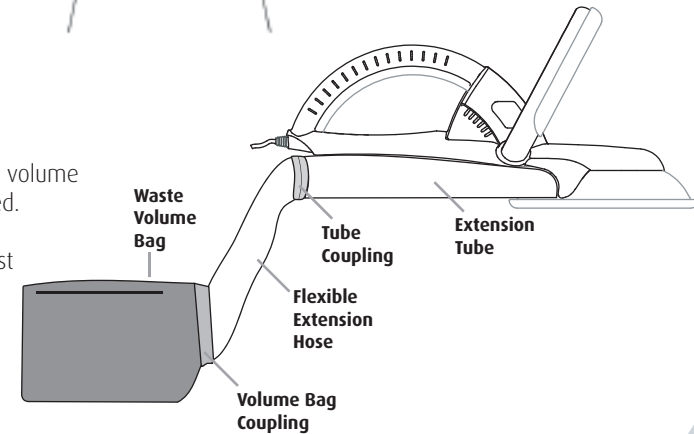

**Tip: When fitting the extension tube, ensure the ridge on the edge of the exhaust hole is covered.

TIP: It is necessary to periodically shake the debris down the hose to ensure smooth conveyance of waste material into the volume bag. When full, detach/unzip from hose and empty into chosen receptacle.



General Power Tool Safety Warnings

WARNING Read all safety warnings and all instructions. Failure to follow the warnings and instructions may result in electric shock, fire and/or serious injury. Save all warnings and instructions for future reference. The term "power tool" in the warnings refers to your mains-operated (corded) power tool or battery-operated (cordless) power tool.

1) Work area safety

- a) **Keep work area clean and well lit.** Cluttered or dark areas invite accidents.
- b) **Do not operate power tools in explosive atmospheres,** such as in the presence of flammable liquids, gases or dust. Power tools create sparks which may ignite the dust or fumes.
- c) **Keep children and bystanders away** while operating a power tool. Distractions can cause you to lose control.

2) Electrical safety

- a) **Power tool plugs must match the outlet.** Never modify the plug in any way. Do not use any adapter plugs with earthed (grounded) power tools. Unmodified plugs and matching outlets will reduce risk of electric shock.
- b) **Avoid body contact with earthed or grounded surfaces,** such as pipes, radiators, ranges and refrigerators. There is an increased risk of electric shock if your body is earthed or grounded.
- c) **Do not expose power tools to rain or wet conditions.** Water entering a power tool will increase the risk of electric shock.
- d) **Do not abuse the cord.** Never use the cord for carrying, pulling or unplugging the power tool. Keep cord away from heat, oil, sharp edges or moving parts. Damaged or entangled cords increase the risk of electric shock.
- e) **When operating a power tool outdoors,** use an extension cord suitable for outdoor use. Use of a cord suitable for outdoor use reduces the risk of electric shock.
- f) **If operating a power tool in a damp location is unavoidable,** use a residual current device (RCD) protected supply. Use of an RCD reduces the risk of electric shock.

3) Personal safety

- a) **Stay alert, watch what you are doing and use common sense** when operating a power tool. Do not use a power tool while you are tired or under the influence of drugs, alcohol or medication. A moment of inattention while operating power tools may result in serious personal injury.
- b) **Use personal protective equipment.** Always wear eye protection. Protective equipment such as dust mask, non-skid safety shoes, hard hat, or hearing protection used for appropriate conditions will reduce personal injuries.
- c) **Prevent unintentional starting.** Ensure the switch is in the off-position before connecting to power source and/or battery pack, picking up or carrying the tool. Carrying power tools with your finger on the switch or energising power tools that have the switch on invites accidents.
- d) **Remove any adjusting key or wrench** before turning the power tool on. A wrench or a key left attached to a rotating part of the power tool may result in personal injury.
- e) **Do not overreach.** Keep proper footing and balance at all times. This enables better control of the power tool in unexpected situations.
- f) **Dress properly.** Do not wear loose clothing or jewellery. Keep your hair, clothing and gloves away from moving parts. Loose clothes, jewellery or long hair can be caught in moving parts.
- g) **If devices are provided for the connection of dust extraction and collection facilities,** ensure these are connected and properly used. Use of dust collection can reduce dust-related hazards.
- h) **We recommend wearing gloves**

4) Power tool use and care

- a) **Do not force the power tool.** Use the correct power tool for your application. The correct power tool will do the job better and safer at the rate for which it was designed.
- b) **Do not use the power tool if the switch does not turn it on and off.** Any power tool that cannot be controlled with the switch is dangerous and must be repaired.
- c) **Disconnect the plug from the power source and/or the battery pack from the power tool before making any adjustments,** changing accessories, or storing power tools. Such preventive safety measures reduce the risk of starting the power tool accidentally.
- d) **Store idle power tools out of the reach of children** and do not allow persons unfamiliar with the power tool or these instructions to operate the power tool. Power tools are dangerous in the hands of untrained users.
- e) **Maintain power tools.** Check for misalignment or binding of moving parts, breakage of parts and any other condition that may affect the power tool's operation. If damaged, have the power tool repaired before use. Many accidents are caused by poorly maintained power tools.
- f) **Keep cutting tools sharp and clean.** Properly maintained cutting tools with sharp cutting edges are less likely to bind and are easier to control.
- g) **Use the power tool, accessories and tool bits etc. in accordance with these instructions,** taking into account the working conditions and the work to be performed. Use of the power tool for operations different from those intended could result in a hazardous situation.

5) Service

Have your power tool serviced by a qualified repair person using only identical replacement parts. This will ensure that the safety of the power tool is maintained. If the replacement of the supply cord is necessary, this has to be done by the manufacturer or his agent in order to avoid a safety hazard.

Hedge trimmer safety warnings:

- Keep all parts of the body away from the cutter blade. Do not remove cut material or hold material to be cut when blades are moving. Make sure the machine is disconnected before clearing jammed material. A moment of inattention while operating the hedge trimmer may result in serious personal injury.
- Carry the hedge trimmer by the handle with the cutter blade stopped. Proper handling of the hedge trimmer will reduce possible personal injury from the cutter blades.
- Keep cable away from cutting area. During operation the cable may be hidden in shrubs and can be accidentally cut by the blade.
- Stop the tool when crossing surfaces other than hedges and when transporting the tool to and from the area to be cut.
- Never operate the Garden Groom Midi without the container fully assembled volume bag attachment
- The operator is responsible for accidents and hazards occurring to other people or their property
- Never tape the switches
- Never use the Garden Groom at eye level
- Always use ladders or a platform when working over head height
- Do not start the machine in situ i.e. buried in hedge

Fig.1 - VOLUME BAG

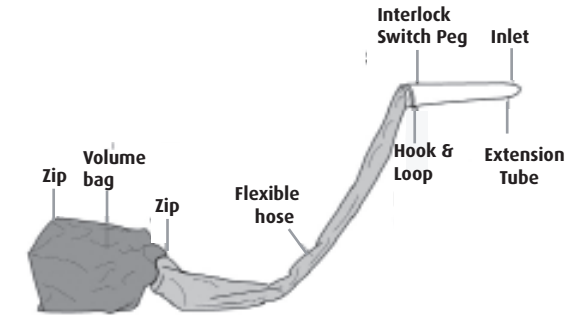

Fig.2 - EXTENSION TUBE

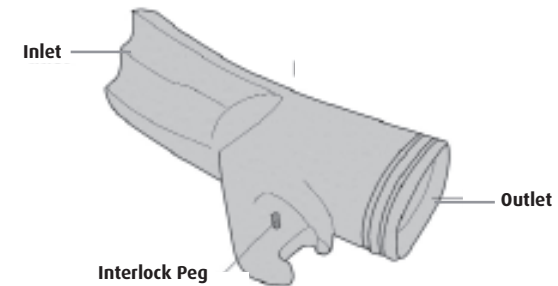
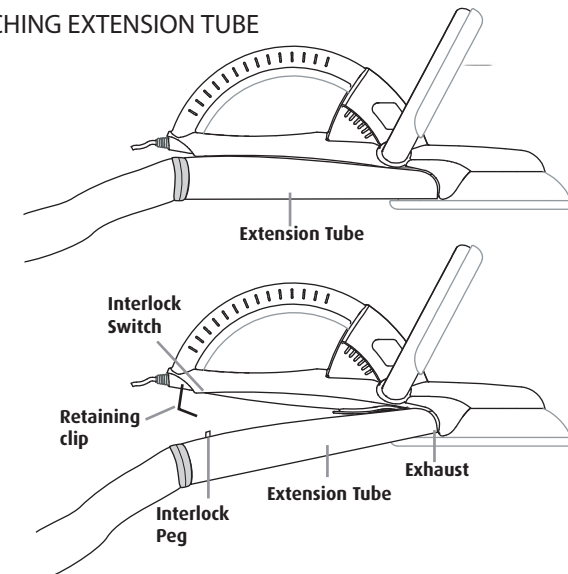

Fig.3 - ATTACHING EXTENSION TUBE





Garden Groom Midi Volume Bag Instructions

Your Volume bag Attachment

The volume bag attachment is supplied fully assembled, (see fig. 1)

Check the assembly for damage and ensure all the component parts are in perfect condition and firmly connected together before proceeding.

Preparing your Volume Bag

Lay the hose, extension tube and bag out in a straight line adjacent to the hedge to be trimmed, positioning the bag behind the anticipated direction of progress. Ensure the hose is not twisted and the bag is sitting square on its flat base.

Attach the extension tube (Fig.2) to your Garden Groom Midi as illustrated (Fig.3), by offering the inlet of the tube to the exhaust of the Groom. Lift the back of the tube up to the underside of the machine, ensuring the interlock peg is aligned with the interlock switch, in the same way as the conventional container

Secure the tube with the retaining clip.

Plug your Garden Groom Midi into the mains electrical supply and switch on.

Your Garden Groom Midi should now be ready for use. If however it does not operate, check the interlock peg is correctly aligned with the switch and the retaining clip is firmly in place. If the problem persists, refer to the Troubleshooting page at the back of the Garden Groom Midi manual.

Use of your Volume Bag Attachment

Start up the Groom in the normal manor by operating the main switch and the front switch, ensuring the safety switch is released on the rear handle. The flexible hose and volume bag will inflate, providing a clear passage for the debris to flow from the Groom exhaust to the bag.

As progress is made, to avoid any restriction of movement and strain on the tube/hose coupling, occasionally pull the bag along by the hose in advance of the cutting location.

During use, minor kinking of the hose is acceptable, however, ensure the tube is not twisted, as this will restrict the flow of waste material.

It will be necessary to periodically shake the debris down the hose to ensure smooth conveyance of material into the volume bag.

When the bag is sufficiently full, unzip the flap at the rear end and pour the shredded material into an appropriate receptacle or onto a compost area.

Working from a ladder

When working from a ladder, always ensure it is stable on solid ground and never overreach.

Take care when positioning the ladder there is sufficient freedom of movement for the mains cable and the flexible tube.

Always ensure the position of the ladder, bag and hose do not cause a potential tripping hazard or create any restriction of movement during the hedge trimming operation.

Storage

Ensure the tube, hose and bag are completely free of waste material before storing away.

Store in a dry clear place free of hazards that could cause damage to any of the component parts.

Safety

Check periodically there are no breaks or damage to the volume bag assembly.

The Garden Groom Midi should never be used without the extension tube or hose in position.

Never insert your hand up the extension tube.

Warning

Always unplug your Garden Groom Midi from the mains electrical supply before carrying out any maintenance.

Damage

The three component parts of the Volume Bag Attachment have been designed for easy detachment. If the extension tube is damaged simply detach the hose by untying the cord.

If the hose is damaged unzip the coupling at the bag and untie the extension tube. For volume bag damage simply unzip the hose.



Always wear protective eyewear

Troubleshooting

Problem	Action
Machine won't start	<ul style="list-style-type: none"> - Check the machine is plugged in to a live supply - Check that the waste container or volume bag extension tube is correctly attached, remove and refit to be sure - Check that you are pressing both main switch and front switch ensuring safety switch has released main switch - Check fuse. - Contact helpline. - Return to dealer.
Machine does not collect	<ul style="list-style-type: none"> - Check collection box is not full. - Check volume bag hose (accessory) is not blocked. - Check exhaust is not blocked. <p>Note: The percentage of collection will vary on the condition and type of hedge being cut.</p>
Damage to static or rotary blade	<ul style="list-style-type: none"> - Unplug the machine immediately - Call the Garden Groom Helpline for spare parts/servicing.

Some of the following symbols may appear on your tool. Please familiarize yourself with their meanings. A correct interpretation of the symbols allows a safer and more effective use of the tool.

SYMBOLS	EXPLANATION
	Protection class II
	Warning - Read the instructions carefully to minimize the risk of injury
	Immediately pull the mains plug from its socket if the supply cable or extension cable are damaged.
	Never use this power tool in the rain.
	Wear ear protection when operating with the hedge trimmer.
	When working with the hedge trimmer, wear safety goggles.
	Wear a protective mask.
	Within the EU, this symbol indicates that this product is not to be disposed of as household waste. Old machines contain valuable recyclable materials, which can harm the environment or human health by uncontrolled waste disposal. Please dispose of the old appliance through appropriate channels



Specification

Model no.	GG10
Input Voltage	230V ~ 50Hz
Rated Power (Watts)	300W
No Load Speed (rpm)	3400/min
Class II Appliance	
Complies with European and British safety and EMC regulations	
Noise levels : Sound pressure level: 82 dB(A), Sound Power Level: 97 dB(A), Vibration level is 4.04 m/s ² .	



The specified vibration emission value according to clause 6.2 of EN 60745-2-15. This value may possibly also be used for another hedge trimmer with the same construction and energy supply.

The specified vibration emission value limits the working hours. If you notice a tingling or discolouration (white) of the fingers then stop working with the tool.

Warning: The actual value of existing vibration emissions while using the machine, may differ from those in the manual respectively by the manufacturer. This can be caused by the following factors to be considered before or during any use:

- Is the machine being used correctly?
- Is the method of cutting the material and is it processed correctly?
- Is the machine being used in accordance with the manual
- Maintain the tool in accordance with the manual

If you observe an uncomfortable feeling or a discoloration of the skin from your hands while using the machine, please immediately stop working. Take adequate breaks from work. Not taking adequate work breaks, may result in hand-arm vibration syndrome.

A degree of noise from this machine is unavoidable, only use at appropriate times of the day.

CONTAINS NO USER SERVICEABLE PARTS

Please retain your receipt! If this product is, or becomes defective, please return it to the place of purchase along with your till receipt.

Manufactured by:

ALLSTAR MARKETING GROUP LLC
HAWTHORNE, NEW YORK 10532, U.S.A

UK Agent:

Garden Groom
PO Box 192
Prenton
Wirral
CH26 9DB

HELP LINE NO: 0151 203 5760

EC- Declaration of Conformity

Herewith we, GARDEN GROOM, PO Box 192, Prenton, Wirral, CH26 9DB declare that the following Appliance complies with the appropriate basic safety and health requirements of the EC Directives (see item 4) based on its design and type, as brought into circulation by us.

This declaration relates exclusively to the machinery in the state in which it was placed on the market, and excludes components which are added and/or operations carried out subsequently by the final user.

Designation/ function:	Hedge Trimmer
Type	GG10 Garden Groom Midi
Serial number:	
Applicable EC Directives:	Machinery Directive 2006/42/EC
Used harmonized Standards:	EN 60745-1:2009, EN 60745-2-15:2009, EN ISO 3744:1994, ISO 11904:1991 EN55014-1: 2006, EN55014-2: 1997/+A1: 2001/+A2: 2008, EN61000-3-3:1995+A1:2001+A2:2005; EN61000-3-2:2006;
Responsible for documentation:	GARDEN GROOM, PO Box 192, Prenton, Wirral, CH26 9DB
Additional used EC Directives:	EMC Directive 2004/108/EC Low Voltage Directive 2006/95/EC Outdoor- Noise- Directive 2000/14/EC
Measured sound pressure level	95,2dB(A)
Guaranteed sound power level	98dB(A)
Conformity assessment method to Annex V/ Directive 2000/14/EC	

Date/Place/Name/Authorized Signature:

01/02/2010, Liverpool, Tony Rolfe

Title of Signatory:

Managing Director

